

TECHNICAL SPECIFICATIONS

Power Supply	: 380 Vac , 50 / 60 Hz (3Phases+N)
Power Consumption	: < 7VA
Ambient Temperature	: -5 °C... +55°C
Control Output	: 1 Inversor, 10A/ 250 Vac
Electrical Life	: 100.000 Ops. (Resistive Load)
Connection Type	: DIN 35 rail or Vertical
Installation(Installation springs behind the box should be pushed outward to enable screwing).	

MOUNTING

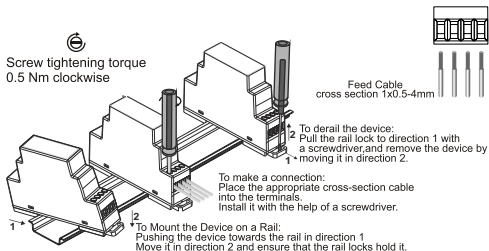

PHASE PROTECTION DEVICE USER GUIDE



**SMK 11
SMK 03**

CORRECT USE AND SAFETY CONDITIONS

- Failure to follow the following instructions may result in injury or death situations may arise.
- The device is suitable for indoor use
- The installation, assembly, commissioning and operation of this device may only be carried out by persons with an appropriate license. must be made and used in accordance with safety regulations and instructions.
- Disconnect all power when the device is connected to and disconnected from the panel.
- Do not remove the front panel while the device is connected to the mains.
- Do not clean the device with solvents or similar substances. Use only dry cloth!
- Check that all connections are correct before operating the device.
- Please do not interfere with the device in case of a technical problem and contact the technical service as soon as possible.
- Do not dispose of the device in the garbage, but take it to device collection centers (electrical and electronic equipment recycling points) must be delivered. Recycle or dispose of without harming nature and human health.
- The device must be used in environments free of flammable and corrosive gases.
- In case of failure to observe the warnings mentioned above, you are responsible for the negative consequences that may arise. Our company or authorized dealer cannot be held responsible in any way.



**CUSTOMER
SUPPORT CENTER**
+90 444 4 575
(From all over Türkiye)

Headquarters : info@krk.com.tr
Order : satis@krk.com.tr
Sales /Support : satis-destek@krk.com.tr
Technical Support : teknik@krk.com.tr
Fax : +90 216 612 36 40
WhatsApp : +90 553 646 57 11

GENERAL SPECIFICATIONS

SMK protection relays desing to protect three phase system againts to voltage fluactitation , and phase error.

The tolerance values and the other fonctions are is the table.

PROTECTION FUNCTIONS

Type	Phase Error	Temperature Protection	Assymetry	Electrical Connection	Weight (kg)
SMK 11	•		%30	PCB Clamp	0,09
SMK 03	•		%40	PCB Clamp	0,09

1) Phase Error: The motor is became off when there are two phases on the system. .

2)Assymetry: When the voltage value exceeds the tolerance value, the motor is became off .

DIMENSIONS

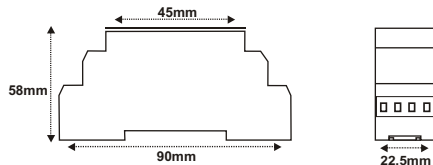

CONNECTION DIAGRAM

