

TECHNICAL SPECIFICATIONS

| Type | Supply | Asymmetry | Temperature Protection | Electrical Connection | Weight (kg) |
|----------|---------------|-----------|------------------------|-----------------------|-------------|
| SFMK 03 | Phase-Neutral | %30 | | PCB Clamp | 0,09 |
| SFMK 03P | Phase-Neutral | %30 | PTC | PCB Clamp | 0,09 |
| SFSR | Phase-Neutral | | | PCB Clamp | 0,09 |
| SFMK A | Phase-Neutral | %5...%30 | | PCB Clamp | 0,09 |
| SFMK AP | Phase-Neutral | %5...%30 | PTC | PCB Clamp | 0,09 |
| FMK 03 | Phase-Neutral | %30 | | PCB Clamp | 0,13 |
| FMK 03P | Phase-Neutral | %30 | PTC | PCB Clamp | 0,13 |

Supply voltage : 380 Vac (%±35, 3 Phases + N), 50/60 Hz.
Hysteresis : % 20 (Asymmetry Value)
Power Consumption : < 7 VA
Ambient Temperature : -5°C...+55°C
Contact Type : 1 Inversor, 10A/ 250 Vac
PTC Resistance : 2 k Ohm
Electrical Connector : PCB Clamp
Electrical Life : 50.000 On/Off (Resistive Load)
Connection Type : DIN 35 rail or Vertical Installation (Installation springs behind the box should be pushed outward to enable screwing).

MOUNTING

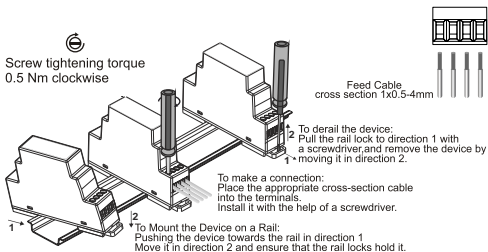

PHASE FAILURE & PHASE SEQUENCE DEVICE USER GUIDE

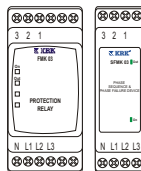

FMK03
SFMK 03P
SFMK 03
SFMK 03P
SFMK A
SFMK AP
SFSR

CORRECT USE AND SAFETY CONDITIONS

- Failure to follow the following instructions may result in injury or death situations may arise.
- The device is suitable for indoor use
- The installation, assembly, commissioning and operation of this device may only be carried out by persons with an appropriate license. must be made and used in accordance with safety regulations and instructions.
- Disconnect all power when the device is connected to and disconnected from the panel.
- Do not remove the front panel while the device is connected to the mains.
- Do not clean the device with solvents or similar substances. Use only dry cloth!
- Check that all connections are correct before operating the device.
- Please do not interfere with the device in case of a technical problem and contact the technical service as soon as possible.
- Do not dispose of the device in the garbage, but take it to device collection centers (electrical and electronic equipment recycling points) must be delivered. Recycle or dispose of without harming nature and human health.
- The device must be used in environments free of flammable and corrosive gases.
- In case of failure to observe the warnings mentioned above, you are responsible for the negative consequences that may arise. Our company or authorized dealer cannot be held responsible in any way.



CUSTOMER SUPPORT CENTER
 +90 444 4 575
 (From all over Türkiye)

Headquarters : info@krk.com.tr
 Order : satis@krk.com.tr
 Sales /Support : satis-destek@krk.com.tr
 Technical Support : teknik@krk.com.tr
 Fax : +90 216 612 36 40
 WhatsApp : +90 553 646 57 11

GENERAL SPECIFICATIONS

SFMK - FMK SERIES: Motor (Phase) Protection Relay with Phase Sequence. It protects motor when one of the phases is cut or its value fluctuates more than asymmetry value, or Phase sequence is wrong and motor overheat.

FSR: It protects motor against wrong phase sequence.

Protection Functions

I- Phase Loss : If systems loses one or two phases device will not give output to protect system by cutting energy.

II-Temperature Protection: If the heat of the motor exceeds PTC's value device will cut output.

III. Voltage Asymmetry: If system's phase-phase voltage values are between the adjusted asymmetry value, "out" led is on (2-3 contacts are closed). Otherwise the output is closed (1-2 contacts are closed).

$$\text{Asymmetry (\%)} = \frac{\text{The max. deviation between Ph-N values}}{\text{Nominal value of Ph-N}} \times 100$$

IV-Phase Sequence Failure : If the sequence of the phases are wrong the output is closed without delay.

IV-PTC Protection: If "PTC" protection isn't desired "PTC" inputs must be short-cut. Otherwise must be connected to the motor. It will protect motor

DIMENSIONS

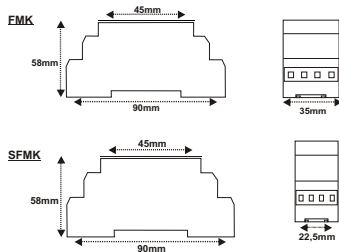

CONNECTION DIAGRAM

FMK SERIES

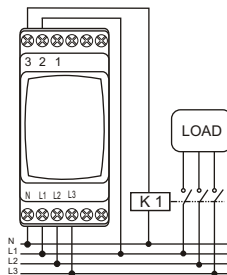

FMK PTC SERIES

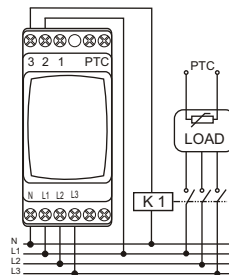

SFMK SERIES

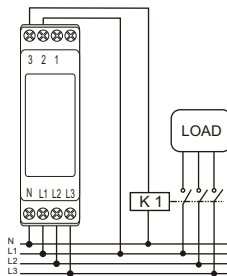

SFMK PTC SERIES

